

Controls & Features

Horn Button

The horn is used to alert other motorists. To operate, push the horn button (3).

Rear Brake Lock

Be sure the rear brake is applied while starting and warming up the engine. The rear brake lock will not function if the rear brake is not adjusted properly (page 115).

To Apply the Brake Lock

Squeeze the rear brake lever (1) and set the brake lock lever (2).

The rear brake lock will not be applied if the rear brake is not adjusted properly (page 115).

LEFT HANDLEBAR

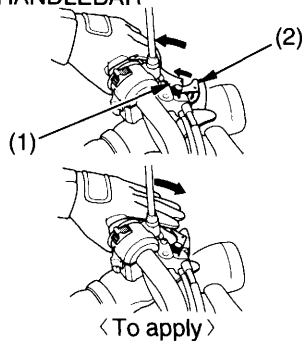

(1) rear brake lever (2) brake lock lever