

Other Inspections & Lubrication

- Check that the clutch lever assembly is positioned properly (the end of the holder (1) is aligned with the paint mark (2) on the handlebar) and the securing bolts are tight.

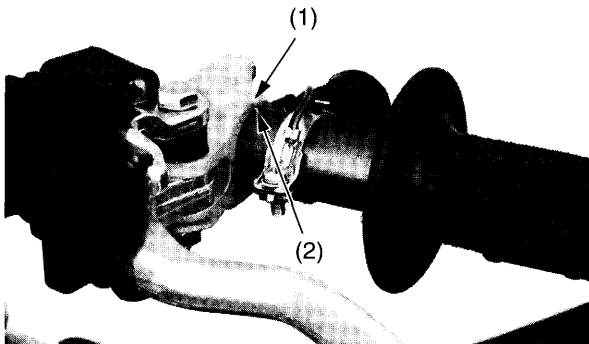

(1) holder (2) paint mark

- Check the clutch cable for kinks or signs of wear. If necessary, have it replaced.
- Lubricate the clutch cable with a commercially-available cable lubricant to prevent premature wear and corrosion.

Clutch Operation

1. Check for smooth clutch lever operation. If necessary, lubricate the clutch lever pivot or clutch cable.
2. Check the clutch cable for deterioration, kinks, or damage.

Clutch Cover/Disc/Plate Removal

1. Drain the transmission oil (page 47).
2. Remove the rear brake pedal (1) by removing the pin (2), pivot bolt (3), washer (4) and dust seals (5).

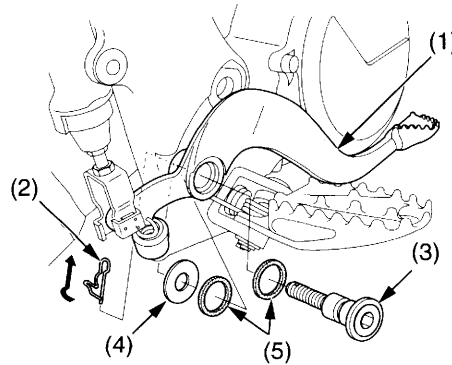

(1) rear brake pedal (2) pin
(3) pivot bolt (4) washer (5) dust seals

3. Remove the six clutch cover bolts (6) and clutch cover (7).

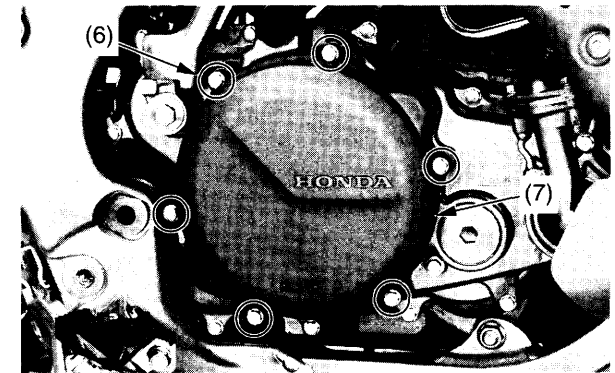

(6) clutch cover bolts (7) clutch cover

4. Remove the six clutch spring bolts and clutch springs (8).

Loosen the clutch spring bolts in a crisscross pattern in two or three progressive steps.

5. Remove the clutch pressure plate (9).

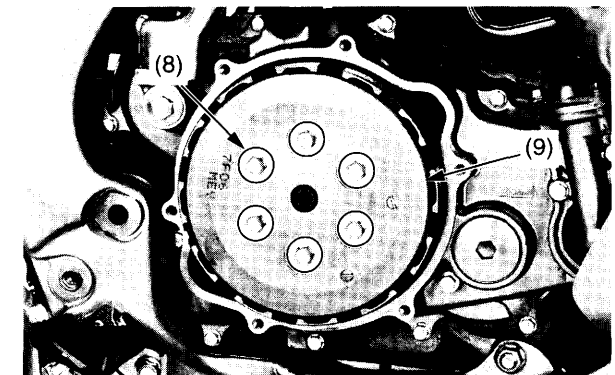

(8) clutch spring bolts/clutch springs
(9) clutch pressure plate

(cont'd)