

- Front: Make sure the brake arm, spring, and fasteners are in good condition.
- Rear: Make sure the brake rod, brake arm, spring, and fasteners are in good condition.

## Rear Brake Pedal Height Adjustment

RIGHT  
SIDE

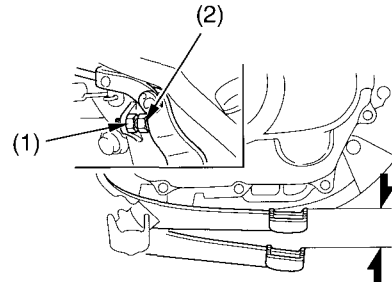

- (1) lock nut  
(2) stopper bolt

1. Loosen the lock nut ( 1 ) and turn the stopper bolt ( 2 ).
2. Tighten the lock nut.
3. Check the freeplay (page 84 ).