

# Refuelling

**Fuel type:** Unleaded petrol only

**Fuel octane number:**

Your motorcycle is designed to use Research Octane Number (RON) 91 or higher

**Tank capacity:** 19 litres (5.0 US gal, 4.2 Imp gal)

**Refuelling and Fuel Guidelines** ➔ P. 15

## Opening the Fuel Fill Cap

- 1 Insert the ignition key into the lock, and turn it counterclockwise to open the fuel tank lid.
- 2 Turn the fuel fill cap counterclockwise and remove it.
- 3 Place the fuel fill cap in the holder of the fuel tank lid.

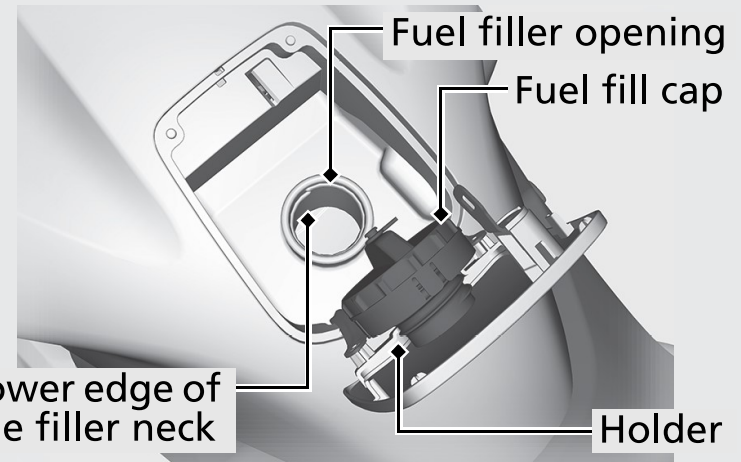
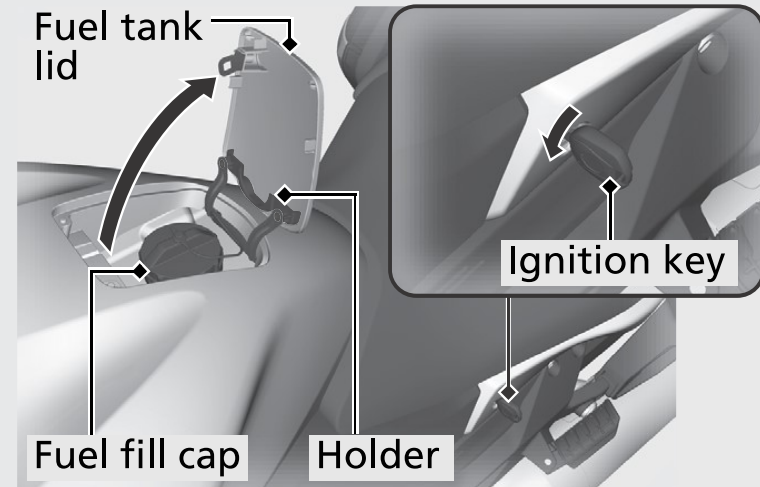

Do not fill with fuel above lower edge of the filler neck.