

FEATURES

(Not required for operation)

STEERING LOCK

To lock the steering, turn the handlebar all the way to the left, turn the ignition switch (1) to LOCK while pushing in.

The ignition switch will lock when leaving with Honda smart card key from the operating range. All of the turn signals flash twice to help you to know it was locked.

To unlock the steering, turn the ignition switch to OFF while pushing in, when the Honda smart card key system is working.

Do not turn the ignition switch to LOCK while riding the scooter; loss of vehicle control will result.

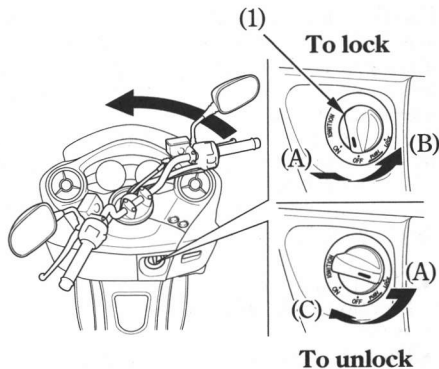

(1) Ignition switch

(A) Push in

(B) Turn to LOCK

(C) Turn to OFF