

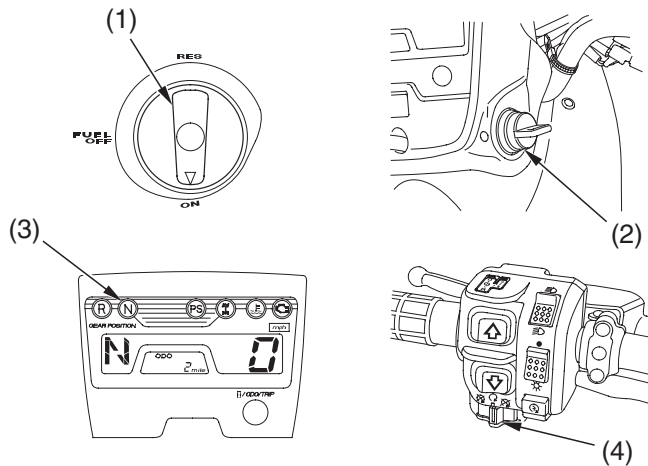

## Starting & Stopping the Engine

### Preparation



- (1) fuel valve  
(2) ignition switch  
(3) neutral indicator  
(4) engine stop switch

1. Before starting, select a level surface and lock the parking brake (page 34).
2. Turn the fuel valve (1) and ignition switch (2) to ON ( | ).

Confirm the following:

- The transmission is in neutral, and the neutral indicator (3) is ON.
- The engine stop switch (4) is set to RUN ( ◯ ).

