

# Engine Oil & Filter

---

2. Stop the engine, place an oil drain pan under the oil tank and \ crankcase. Remove the oil filler cap, the drain plug (1) on the oil tank and drain plug (2) on the crankcase.

UNDER ENGINE

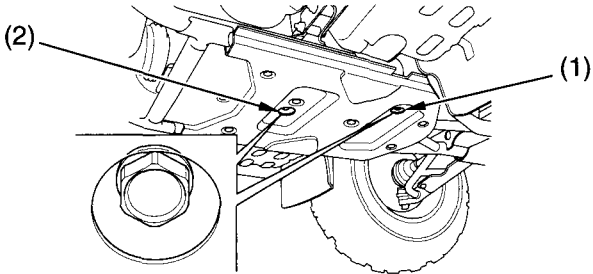

- (1) drain plug (oil tank)
- (2) drain plug (crankcase)

*Install a New Engine Oil Filter:*

3. Remove the front engine guard (3) by removing the mount bolts (4).

UNDER ENGINE

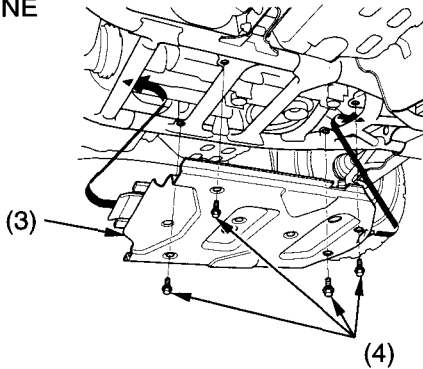

- (3) engine guard
- (4) bolts