

Installation:

1. Position the wheel between the fork legs and insert the front axle shaft from the left side, through the left fork leg and wheel hub.

To avoid damaging the brake pads while installing the wheel, carefully fit the brake disc between the pads.

2. Position the lug (6) on the speedometer gearbox against the left fork leg.
3. Align the index line (7) of the axle shaft with the surface (8) of fork leg.
4. Tighten the axle pinch bolts on the left fork leg to the specified torque:
22 N·m (2.2 kgf·m , 16 lbf·ft)
5. Tighten the axle bolt to the specified torque:
59 N·m (6.0 kgf·m , 43 lbf·ft)
6. Operate the front brake and pump the fork several times. Check for free wheel rotation after the brake is released. Recheck the wheel if the brake drags or the wheel does not rotate freely.
7. Tighten the axle pinch bolts on the right fork leg to specified torque:
22 N·m (2.2 kgf·m , 16 lbf·ft)

8. Install the speedosensor and tighten the screw securely.

▲WARNING

*** If a torque wrench was not used for installation, see your Honda dealer as soon as possible to verify proper assembly. Improper assembly may lead to loss of braking capacity.**

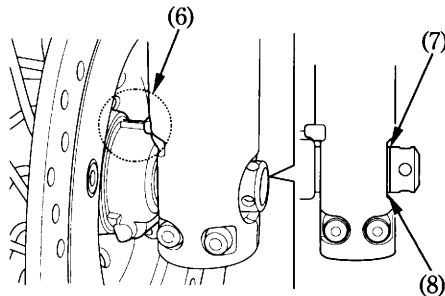

(6) Lugs
(7) Index line

(8) Surface