

If a Fuse Blows

LEFT SIDE

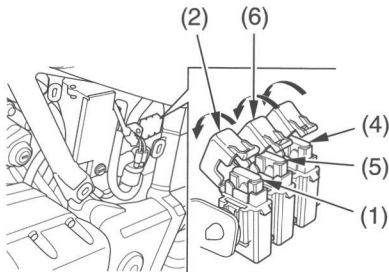

- (1) main fuse A
- (2) main fuse A cover
- (4) spare main fuse
- (5) main fuse B
- (6) main fuse B cover

Main Fuse Access:

2. Remove the left side cover (page 82).
3. To access main fuse A (1), open the main fuse A cover (2).
4. Pull the main fuse A out.
If it is blown (3), install the spare main fuse (4).

MAIN FUSE

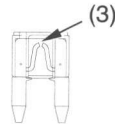

(3) blown fuse

5. Close the main fuse A cover.
6. To access main fuse B (5), open the main fuse B cover (6).
7. Pull the main fuse B out.
If it is blown, install the spare main fuse.

(cont'd)