

## ENGINE OIL

### Engine Oil Level Check

Check the engine oil level each day before riding the motorcycle.

The level must be maintained between the upper (2) and lower (3) level marks on the dipstick (1).

1. With the motorcycle held upright on firm, level ground, start the engine and let it idle for a few minutes.
2. Stop the engine and remove the oil filler cap/dipstick, wipe it clean, and reinsert the dipstick, without screwing it in. The oil level should be between the upper and lower marks on the dipstick.
3. If required, add the specified oil up to the upper level mark (See page 49). Do not overfill.
4. Reinstall the oil filler cap/dipstick. Check for oil leaks.

### CAUTION:

- \* Running the engine with insufficient oil can cause serious engine damage.

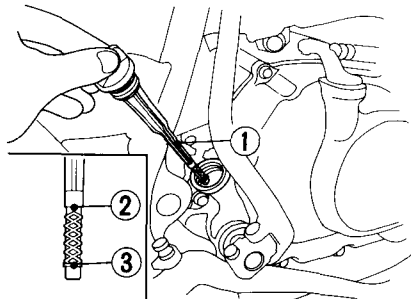

- (1) Oil filler cap/dipstick
- (2) Upper level mark
- (3) Lower level mark