

## Storage Equipment *(Continued)*

### ■ To Close the Fairing Pocket

To close the fairing pocket, push the lid until it is firmly closed.

- ▶ Do not store valuables in the fairing pocket.
- ▶ Make sure the fairing pocket is closed before riding.
- ▶ Be careful not to flood this area when washing your motorcycle.

### Using the remote transmitter

To allow a person who does not possess the Honda SMART Key to open compartments, press the UNLOCK button on the Honda SMART Key (Turn signals blink 2 times).

When the UNLOCK button is pressed, the compartments can be opened by someone who does not have the Honda SMART Key.

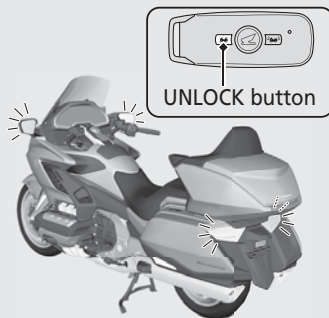

If you press the UNLOCK button, but nobody opens any of the compartments within about 30 seconds or about 30 seconds have passed after an opened compartment is closed, the compartments automatically will relock (Turn signals blinks once).

- ▶ When the 30 days have passed after the ignition switch is turned to OFF or after the buttons of the Honda SMART Key is operated, the remote transmitter will no longer operate. To reset the system, turn the ignition switch ON once and then OFF.