

Refueling

This motorcycle must be opened the rear seat for refueling.

Rear Seat

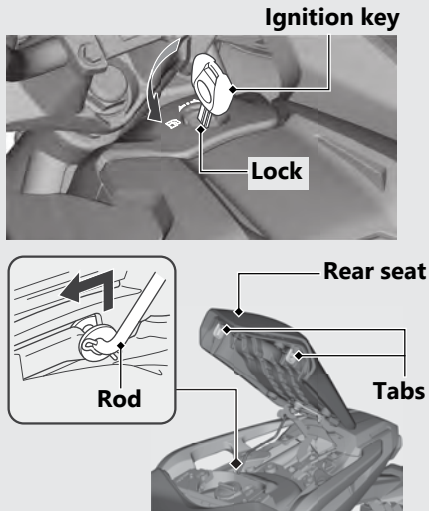

Open

- ① Insert the ignition key into the lock, and turn the key counterclockwise.
- ② Pull up the front of the rear seat.

Close

- ① Pull up the rod upward.
- ② Push down the front of the rear seat until it locks in place.
 - ▶ Make sure that the tabs are locked securely in position to pull up the front of the rear seat lightly.
 - ▶ The seat locks automatically when closed.Take care not to lock your key in the compartment under the rear seat.
- ③ Remove the key.