

INSTALLATION

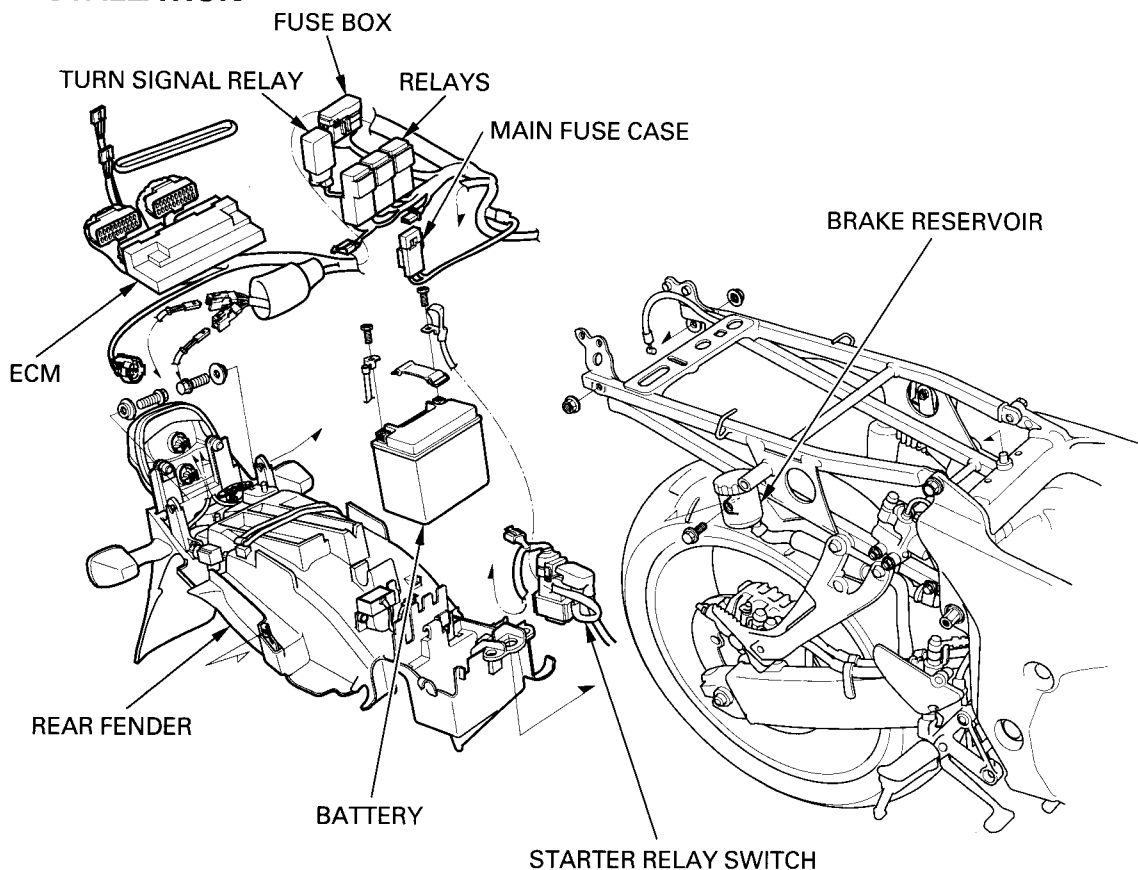

Install the rear fender into the seat rail, while aligning the front groove of the rear fender with the cross bar.

NOTE:

While installing the rear fender, route the wire harness properly (page 1-24).



Install the front end of the rear fender onto the rear shock absorber upper bracket bolt and radiator reserve tank.

CAUTION:

Be careful not to damage the harness guide of the rear fender.

